

**DEPARTMENT OF ENVIRONMENTAL PROTECTION  
WATERWAYS REGULATION PROGRAM**

**Notice of License Application pursuant to M. G. L. Chapter 91  
Waterways License Application Number W07-2146  
Boston Redevelopment Authority**

**NOTIFICATION DATE: December 14, 2007**

Public notice is hereby given of the application by Boston Redevelopment Authority to construct and maintain a pier and float system; relocate docks from Pier 4 to Pier 3; install steel sheet pile bulkhead; and removal of a dilapidated pier at the Charlestown Navy Yard in the municipality of Boston in and over flowed and filled tidelands of Boston Harbor. The proposed use of the project is to provide access to navigable waters and to provide shoreline stabilization and is a water dependent project.

The Department will consider all written comments on this Waterways application received by within 30 days subsequent to the "Notification Date". Failure of any aggrieved person or group of ten citizens or more to submit written comments to the Waterways Regulation Program by the Public Comments Deadline will result in the waiver of any right to an adjudicatory hearing in accordance with 310 CMR 9.13(4)(c).

Additional information regarding this application may be obtained by contacting the Waterways Regulation Program at (617) 654-6520. Project plans and documents for this application are on file with the Waterways Regulation Program for public viewing, by appointment only, at the address below. Written comments must be addressed to: David Slagle, WRP, One Winter St., 5<sup>th</sup> fl., Boston, MA 02108.

**RECEIVED**

**DEC 7 - 2007**

**MEPA**

I CERTIFY THAT THIS PLAN  
AS PREPARED CONFORMS TO  
THE RULES AND REGULATIONS  
OF THE REGISTERS OF DEEDS.

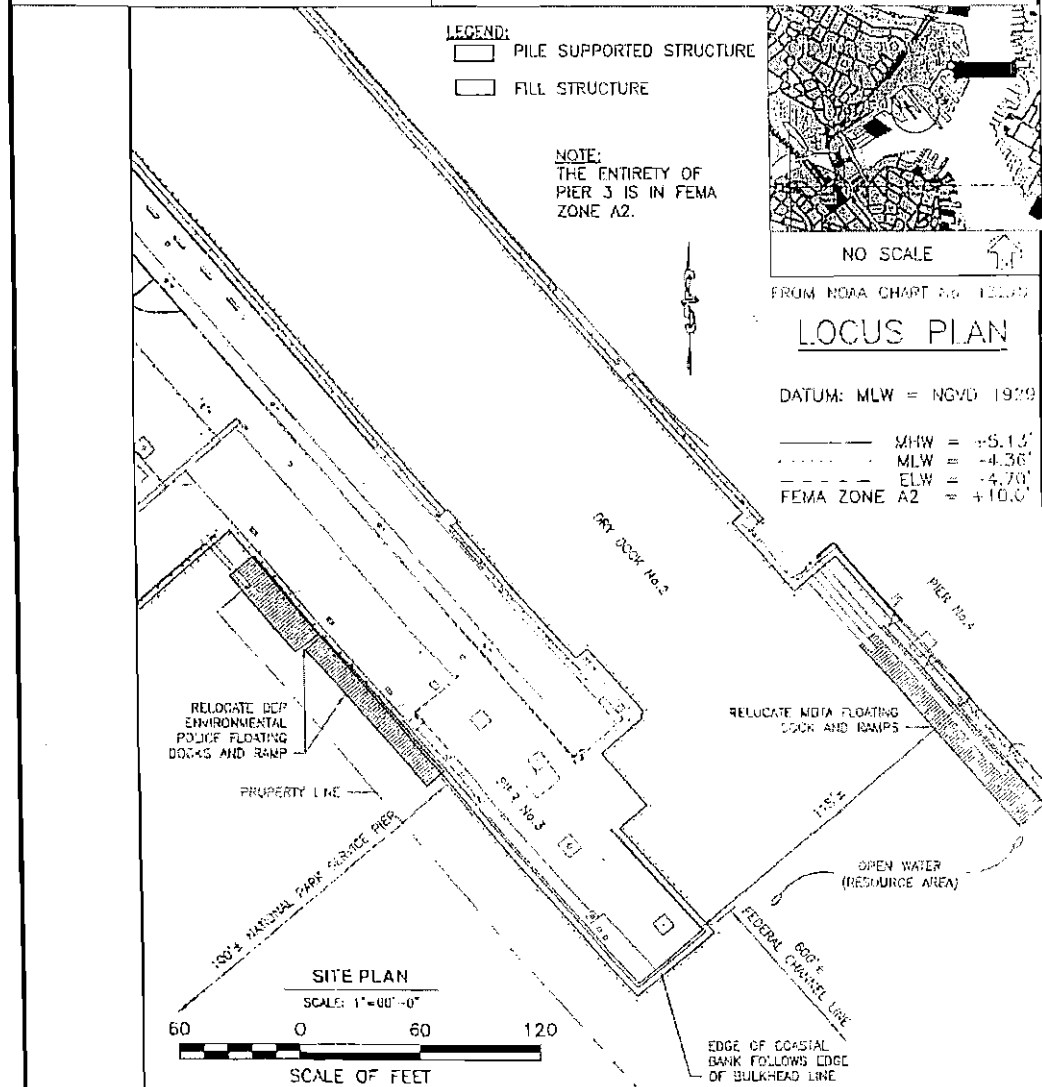

PLANS ACCOMPANYING PETITION OF  
THE BOSTON REDEVELOPMENT AUTHORITY  
TO DEMOLISH EXISTING TIMBER PIER,  
INSTALL STEEL SHEETPILE BULKHEAD,  
RELOCATE EXISTING FLOAT, INSTALL NEW  
STEEL FLOAT AND NEW BITUMINOUS  
PAVING AT PIER 3 - CHARLESTOWN  
COUNTY OF SUFFOLK, MASSACHUSETTS  
OCTOBER, 2007

SHEET 1 OF 10

I CERTIFY THAT THIS PLAN AS PREPARED CONFORMS TO THE RULES AND REGULATIONS OF THE REGISTERS OF DEEDS.

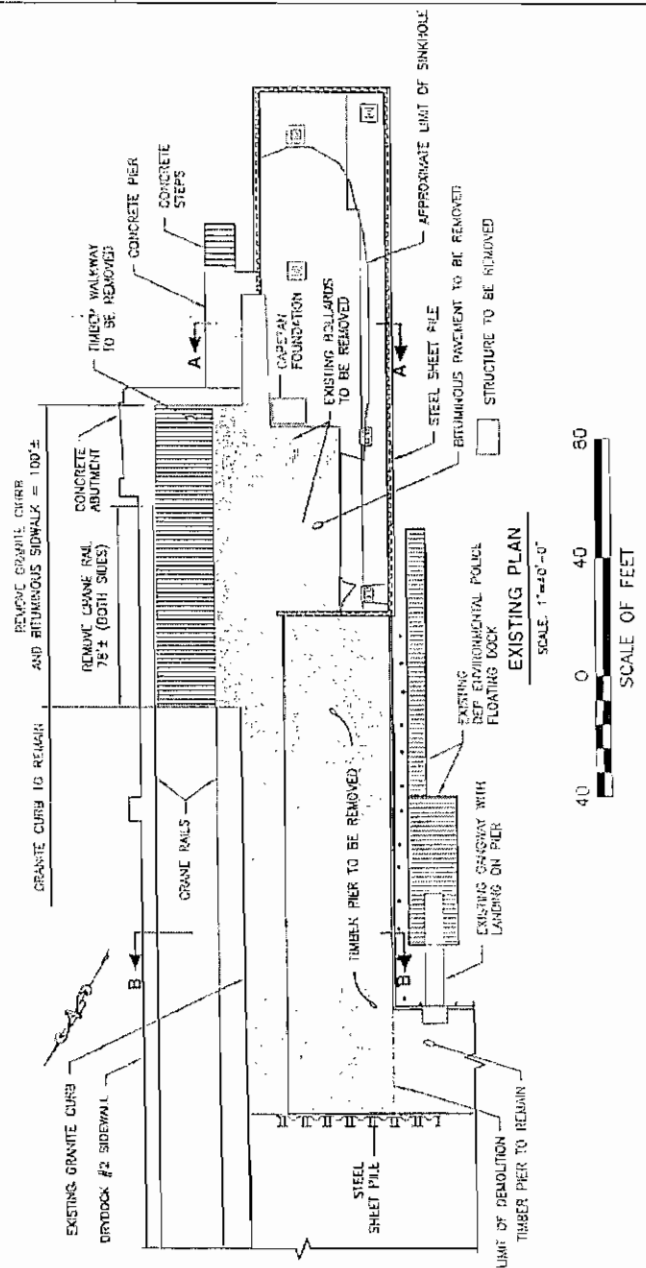

EXISTING PLAN

SCALE: 1"=40'-0"

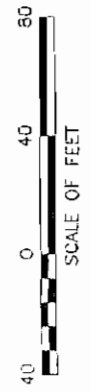

I CERTIFY THAT THIS PLAN  
 AS PREPARED CONFORMS TO  
 THE RULES AND REGULATIONS  
 OF THE REGISTERS OF DEEDS.

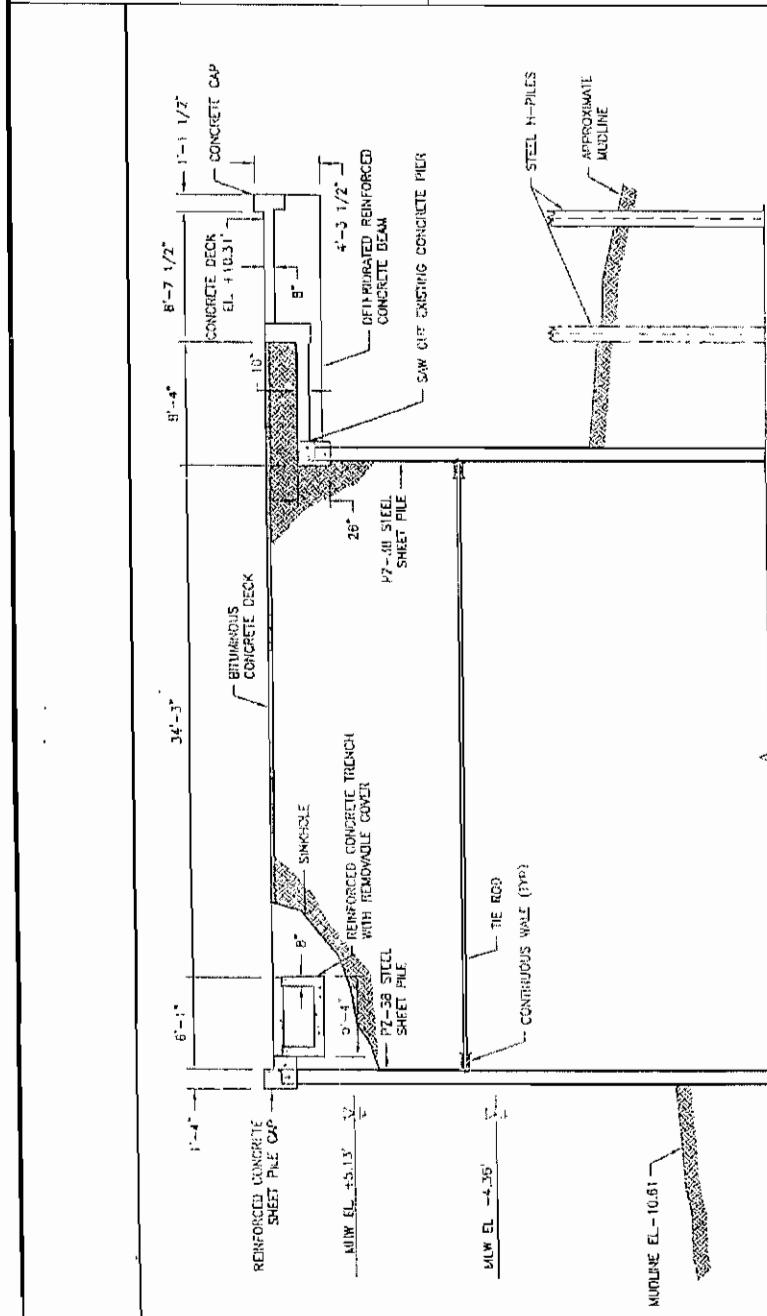

EXISTING SECTION A-A

SCALE: 1/8" = 1'-0"



STRUCTURE TO BE REMOVED

I CERTIFY THAT THIS PLAN  
AS PREPARED CONFORMS TO  
THE RULES AND REGULATIONS  
OF THE REGISTERS OF DEEDS.

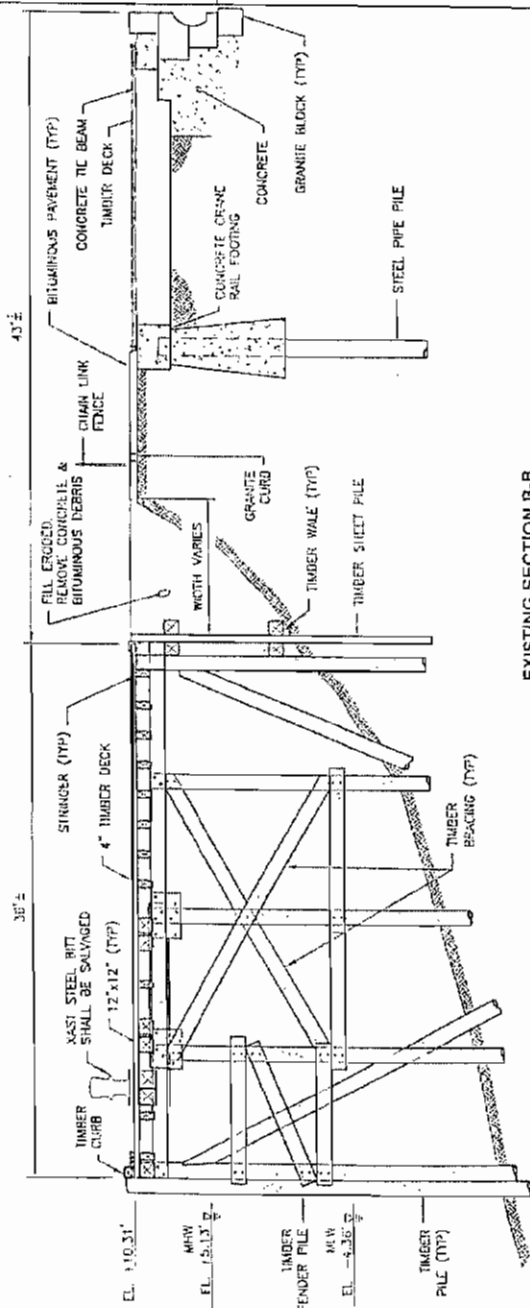

EXISTING SECTION B-B

SCALE 1/8"=1'-0"

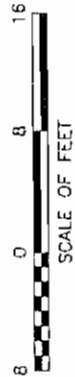

STRUCTURE TO BE REMOVED



I CERTIFY THAT THIS PLAN  
 AS PREPARED CONFORMS TO  
 THE RULES AND REGULATIONS  
 OF THE REGISTERS OF DEEDS.

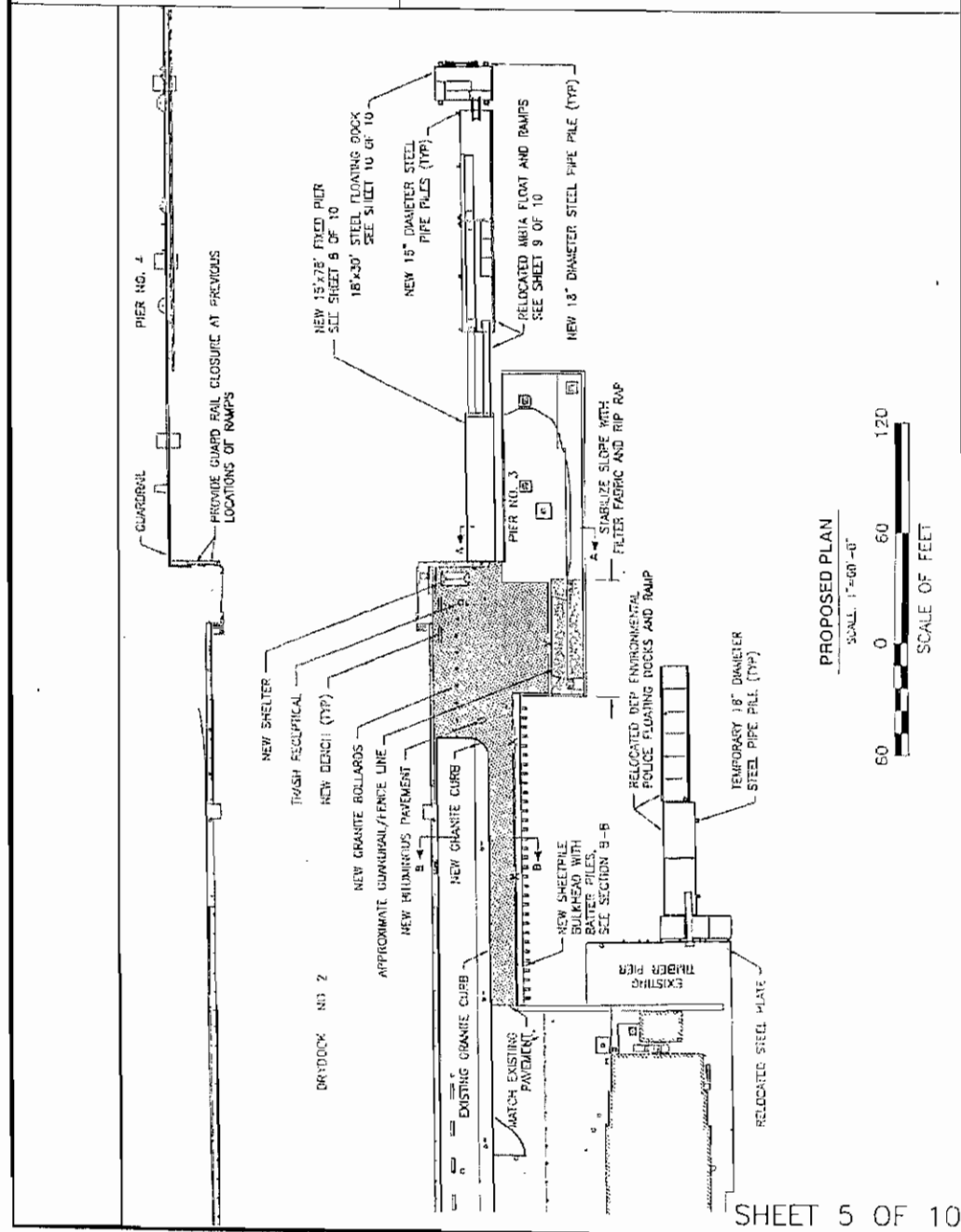

PROPOSED PLAN  
 SCALE: 1"=60'-0"  
 60 0 60 120  
 SCALE OF FEET

I CERTIFY THAT THIS PLAN  
 AS PREPARED CONFORMS TO  
 THE RULES AND REGULATIONS  
 OF THE REGISTERS OF DEEDS.

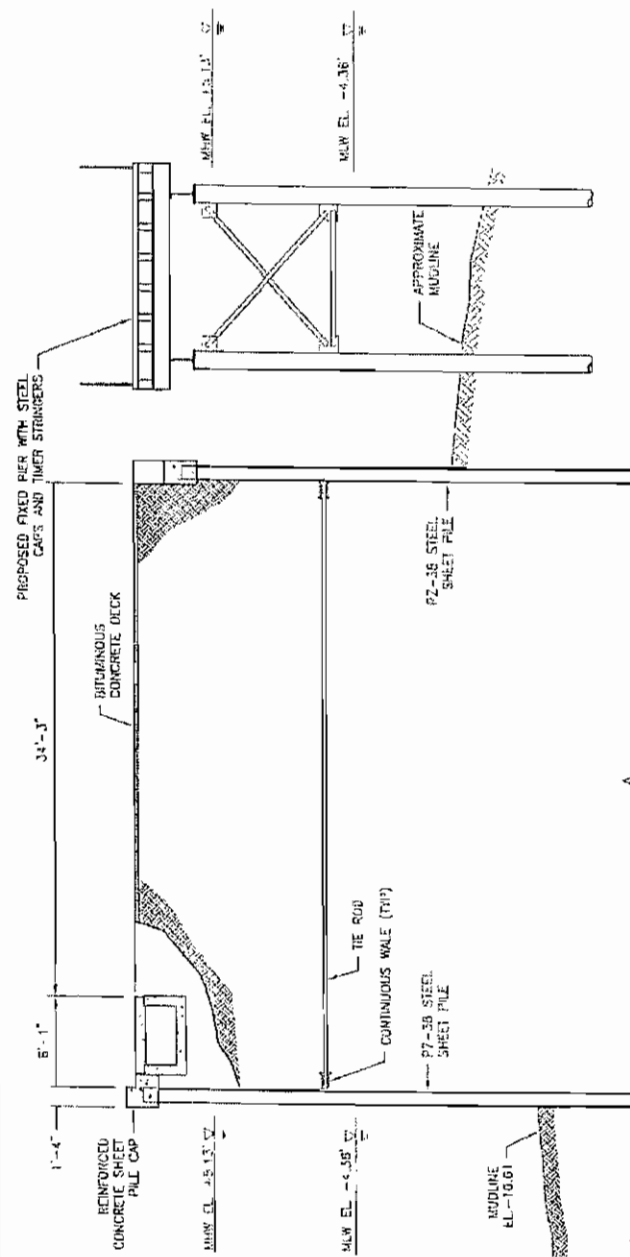

PROPOSED SECTION A-A  
 SCALE: 1/8" = 1'-0"

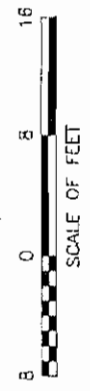

I CERTIFY THAT THIS PLAN  
 AS PREPARED CONFORMS TO  
 THE RULES AND REGULATIONS  
 OF THE REGISTERS OF DEEDS.

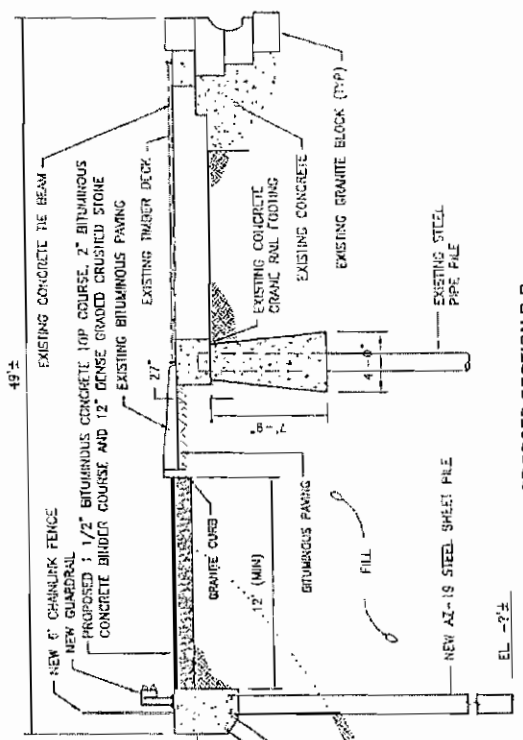

PROPOSED SECTION B-B  
 SCALE: 1/8"=1'-0"

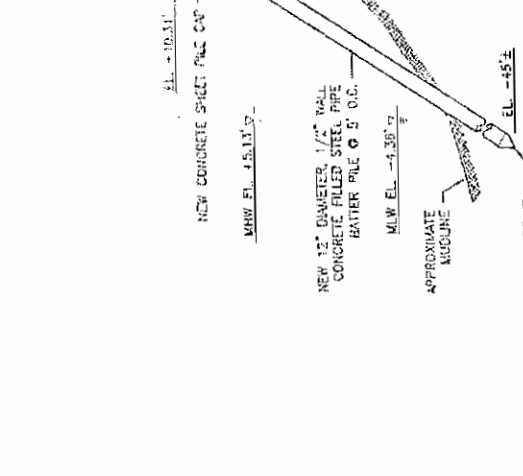

60' CONICAL-INTERIOR FLANGE PILE POINT  
 DRIVEN TO RESISTANCE IN FILL LAYER



I CERTIFY THAT THIS PLAN  
 AS PREPARED CONFORMS TO  
 THE RULES AND REGULATIONS  
 OF THE REGISTERS OF DEEDS.

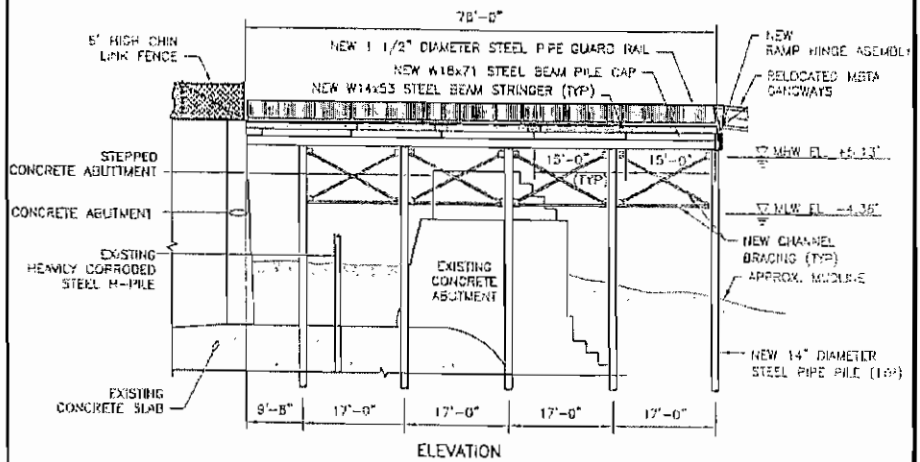
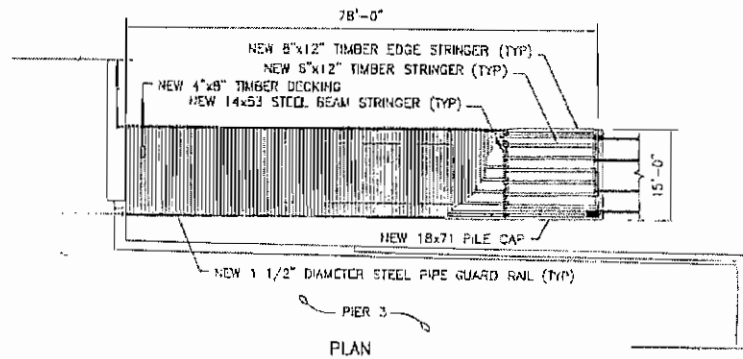

**PROPOSED TIMBER PIER**

SCALE: 1"=20'-0"

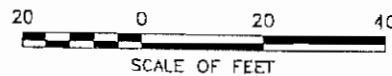

I CERTIFY THAT THIS PLAN  
AS PREPARED CONFORMS TO  
THE RULES AND REGULATIONS  
OF THE REGISTERS OF DEEDS.

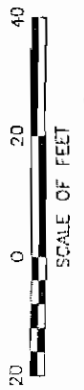
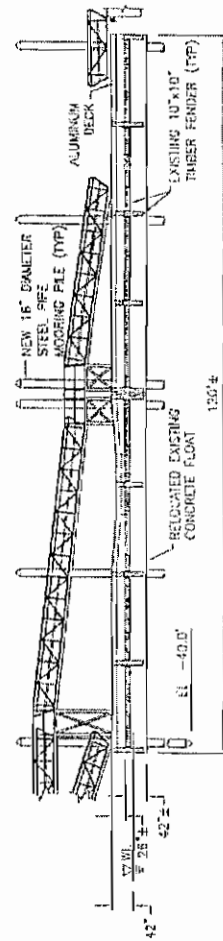
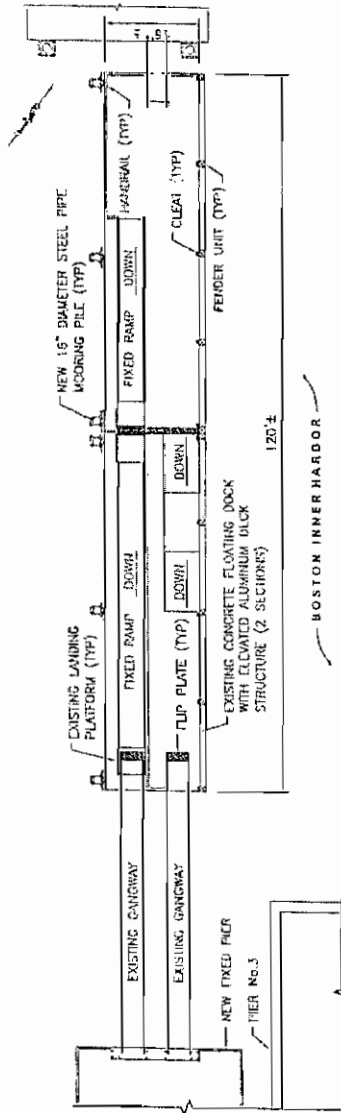

I CERTIFY THAT THIS PLAN  
 AS PREPARED CONFORMS TO  
 THE RULES AND REGULATIONS  
 OF THE REGISTERS OF DEEDS.

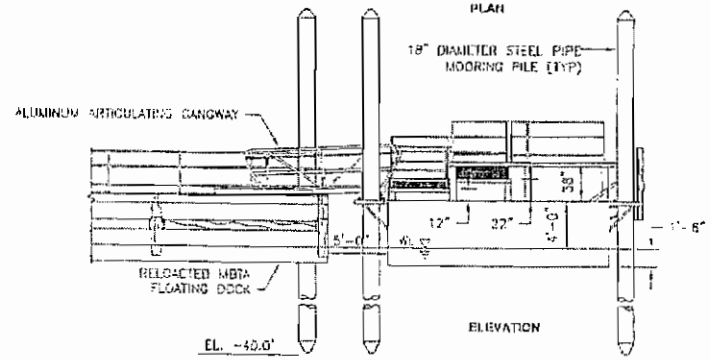
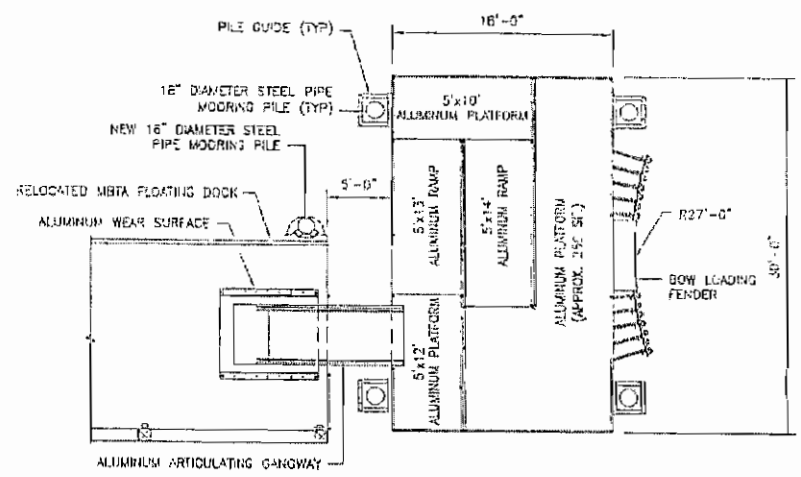

**PROPOSED STEEL FLOATING DOCK**  
 SCALE: 1"=10'-0"

