

KAIROS ENVIRONMENTAL, INC.

P.O. BOX 1088
NEWBURYPORT MA 01950

PH. 978-388-6566
Fax. 978 388-3626

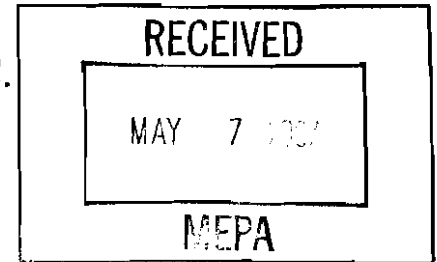

April 27, 2007

LETTER OF TRANSMITTAL

TO: Municipal Officials & Abutters of 4 Jefferson Street

RE: WATERWAYS LICENSE APPLICATION W07-1955

PURSUANT TO 310 CMR 9.13(1)(a), THE APPLICANT LISTED ABOVE IS REQUIRED TO PROVIDE THIS NOTIFICATION, ALONG WITH A COPY OF THE PROJECT SITE PLANS TO THE APPROPRIATE MUNICIPAL OFFICIALS, REGULATORY AGENCIES AND ABUTTERS FOR THEIR REVIEW AND COMMENT; THEREFORE, AS REPRESENTATIVE FOR THE APPLICANT, WE ARE FORWARDING THE FOLLOWING:

**DEPARTMENT OF ENVIRONMENTAL PROTECTION
WATERWAYS REGULATION PROGRAM**

**Notice of License Application pursuant to M. G. L. Chapter 91
Waterways License Application Number W07-1955
Emmett Horgan**

NOTIFICATION DATE: May 13, 2007

Public notice is hereby given of the application by Emmett Horgan to construct and maintain a pier, gangway and bottom-anchored floats at 4 Jefferson Street in the municipality of Newburyport in and over flowed tidelands of the Merrimack River. The proposed use of the project is to provide docking and boating access to navigable waters and is a water dependent project.

The Department will consider all written comments on this Waterways application received by within 30 days subsequent to the "Notification Date". Failure of any aggrieved person or group of ten citizens or more to submit written comments to the Waterways Regulation Program by the Public Comments Deadline will result in the waiver of any right to an adjudicatory hearing in accordance with 310 CMR 9.13(4)(c).

Additional information regarding this application may be obtained by contacting the Waterways Regulation Program at (617) 292-5500. Project plans and documents for this application are on file with the Waterways Regulation Program for public viewing, by appointment only, at the address below. Written comments must be addressed to: Ben Lynch, Program Chief, WRP, One Winter St., 5th fl., Boston, MA 02108.

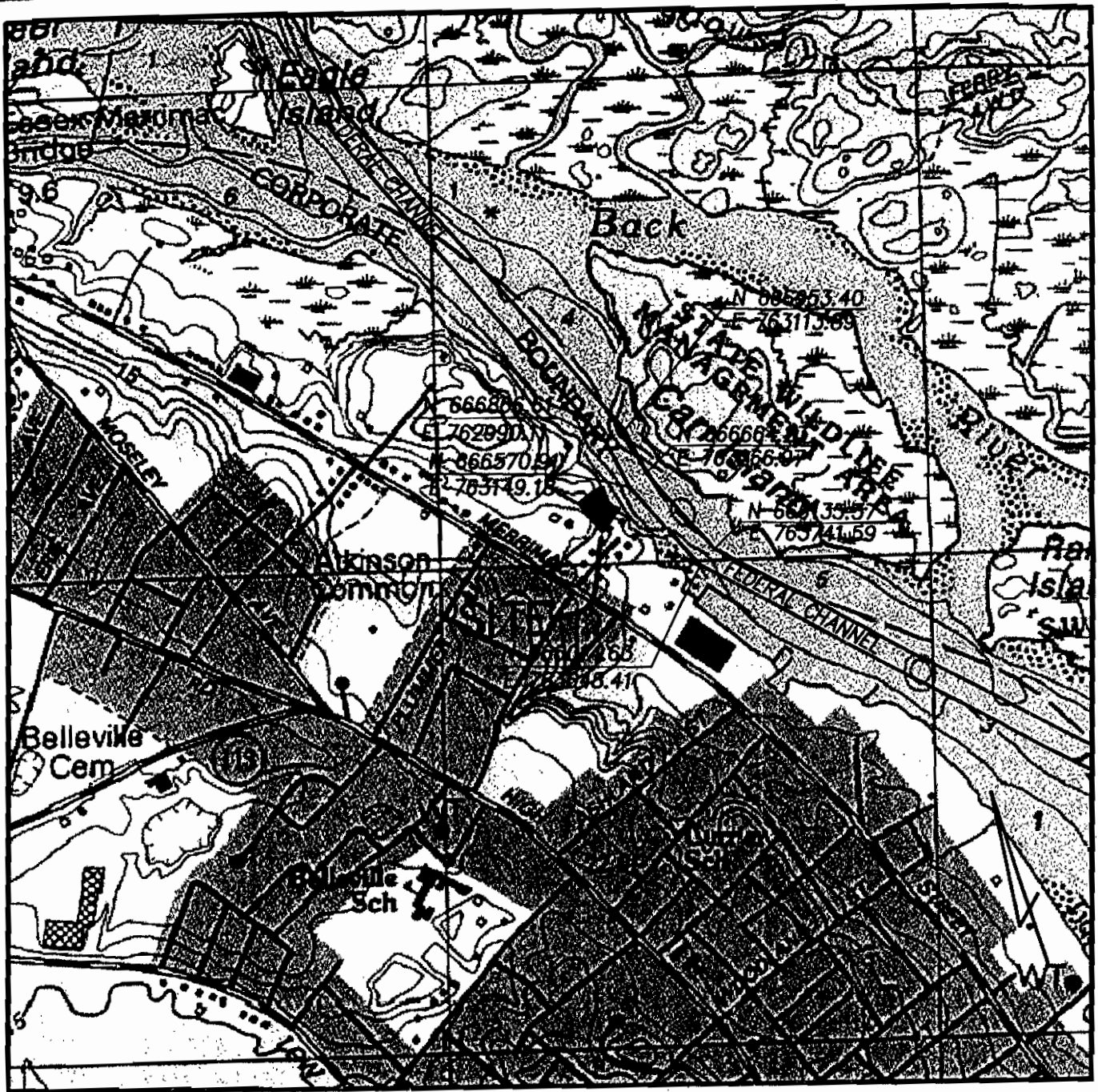

NOTE: COORDINATES FOR EDGES OF FEDERAL CHANNEL SHOWN HEREON WERE TAKEN FROM US ARMY CORPS OF ENGINEERS PLAN ENTITLED "MERRIMACK RIVER, MASSACHUSETTS, SWEEP/CONDITION SURVEY, 7-FOOT CHANNEL," SHEETS 2-7 OF 32.

GRAPHIC SCALE

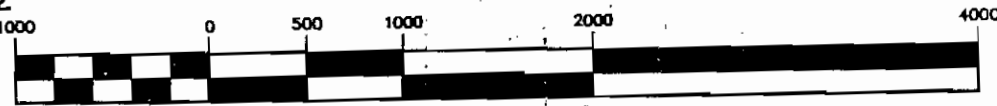

(IN FEET)
1 inch = 1000 ft.

PORT ENGINEERING ASSOCIATES, INC. ONE HARRIS STREET, NEWBURYPORT, MA

PLAN ACCOMPANYING PETITION OF:
EMMETT & CAROLYN HORGAN
 TO CONSTRUCT AN ELEVATED BOARDWALK, GANGWAY AND
 BOTTOM ANCHORED FLOATS IN THE MERRIMACK RIVER,
 NEWBURYPORT, MA, ESSEX COUNTY
 NOAA-NOS/CENED TIDAL DATUM PROJECT
 MLW=0.00; MHW=7.80±
 (CONVERSION: MSL=MLW-3.0)

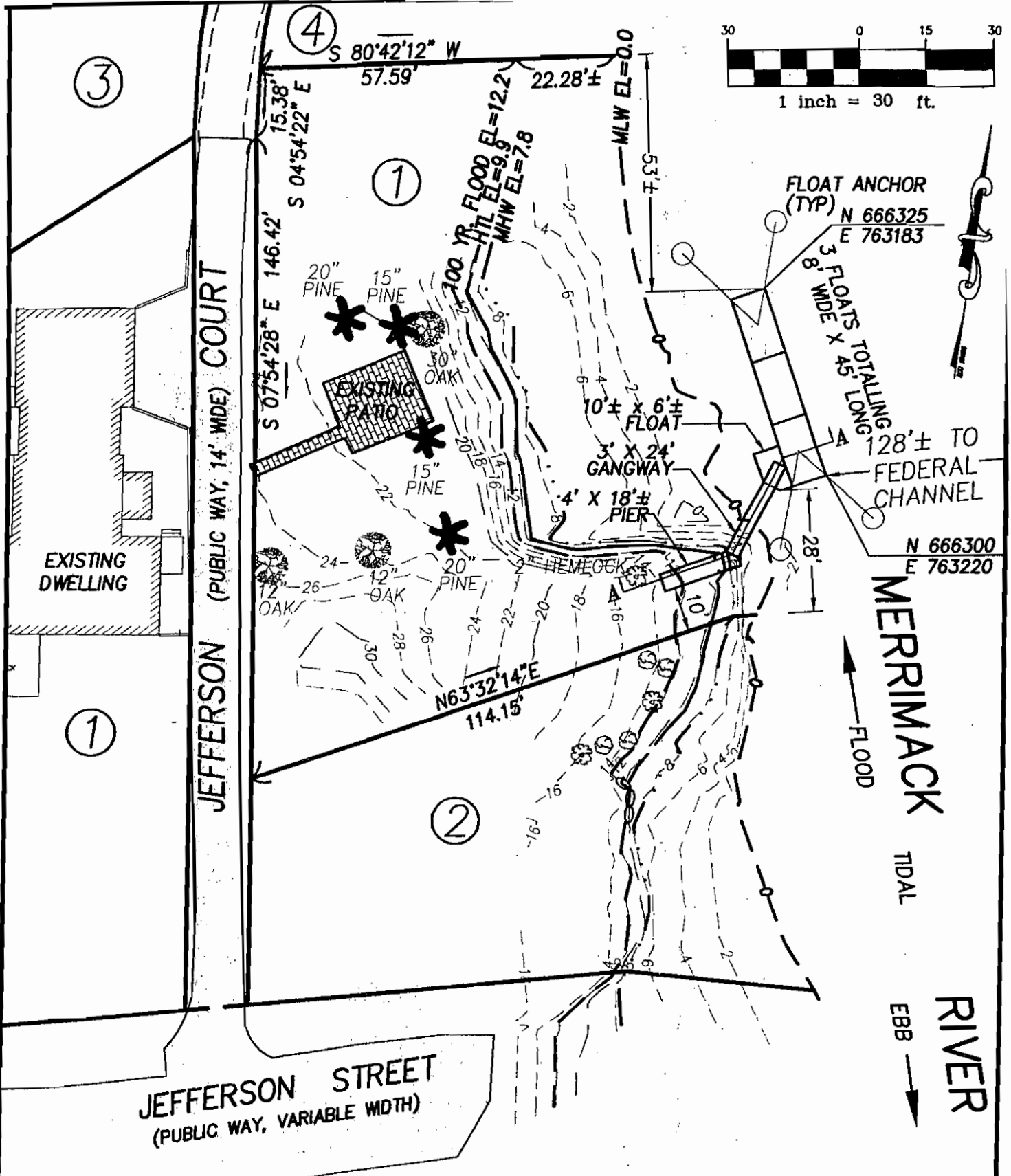
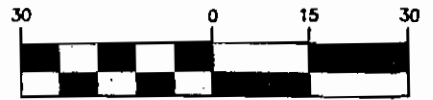

PORT ENGINEERING ASSOCIATES, INC. ONE HARRIS STREET, NEWBURYPORT, MA

PLAN ACCOMPANYING PETITION OF:
 EMMETT & CAROLYN HORGAN
 TO CONSTRUCT AN ELEVATED BOARDWALK, GANGWAY AND
 BOTTOM ANCHORED FLOATS IN THE MERRIMACK RIVER,
 NEWBURYPORT, MA, ESSEX COUNTY
 NOAA-NOS/CENED TIDAL DATUM PROJECT
 MLW=0.00, MHW=7.80±
 (CONVERSION: MSL=MLW-3.0)

ABUTTER REFERENCES

①

LOCUS REFERENCE

MAP 68 LOT 10

N/F EMMETT & CAROLYN HORGAN
4 JEFFERSON STREET, NEWBURYPORT, MA
E.S.D.R.D. BOOK 25845 PAGE 488

②

MAP 68 LOT 14

N/F KIMBERLEY A. DEPIERO, TRUSTEE
2 JEFFERSON STREET REALTY TRUST
2 JEFFERSON STREET, NEWBURYPORT, MA
E.S.D.R.D. BOOK 25957 PAGE 218

③

MAP 68 LOT 11

N/F ROBERTA CORCORAN
SUZANNE T. HITCHCOCK-BRYANT
E.S.D.R.D. BK. 6327 PG. 636

④

MAP 68 LOT 12

N/F ALEXANDRA & GREGORY N. COIR
E.S.D.R.D. BK. 18966 PG. 492
SEE PLAN REF. No. 2

PORT ENGINEERING ASSOCIATES, INC. ONE HARRIS STREET, NEWBURYPORT, MA

PLAN ACCOMPANYING PETITION OF:

EMMETT & CAROLYN HORGAN

TO CONSTRUCT AN ELEVATED BOARDWALK, GANGWAY AND
BOTTOM ANCHORED FLOATS IN THE MERRIMACK RIVER,
NEWBURYPORT, MA, ESSEX COUNTY

NOAA-NOS/CENED TIDAL DATUM PROJECT

MLW=0.00, MHW=7.80±

(CONVERSION: MSL=MLW-3.0)

MARCH 29, 2007; REV: 04/17/07

SHEET 3 OF 7

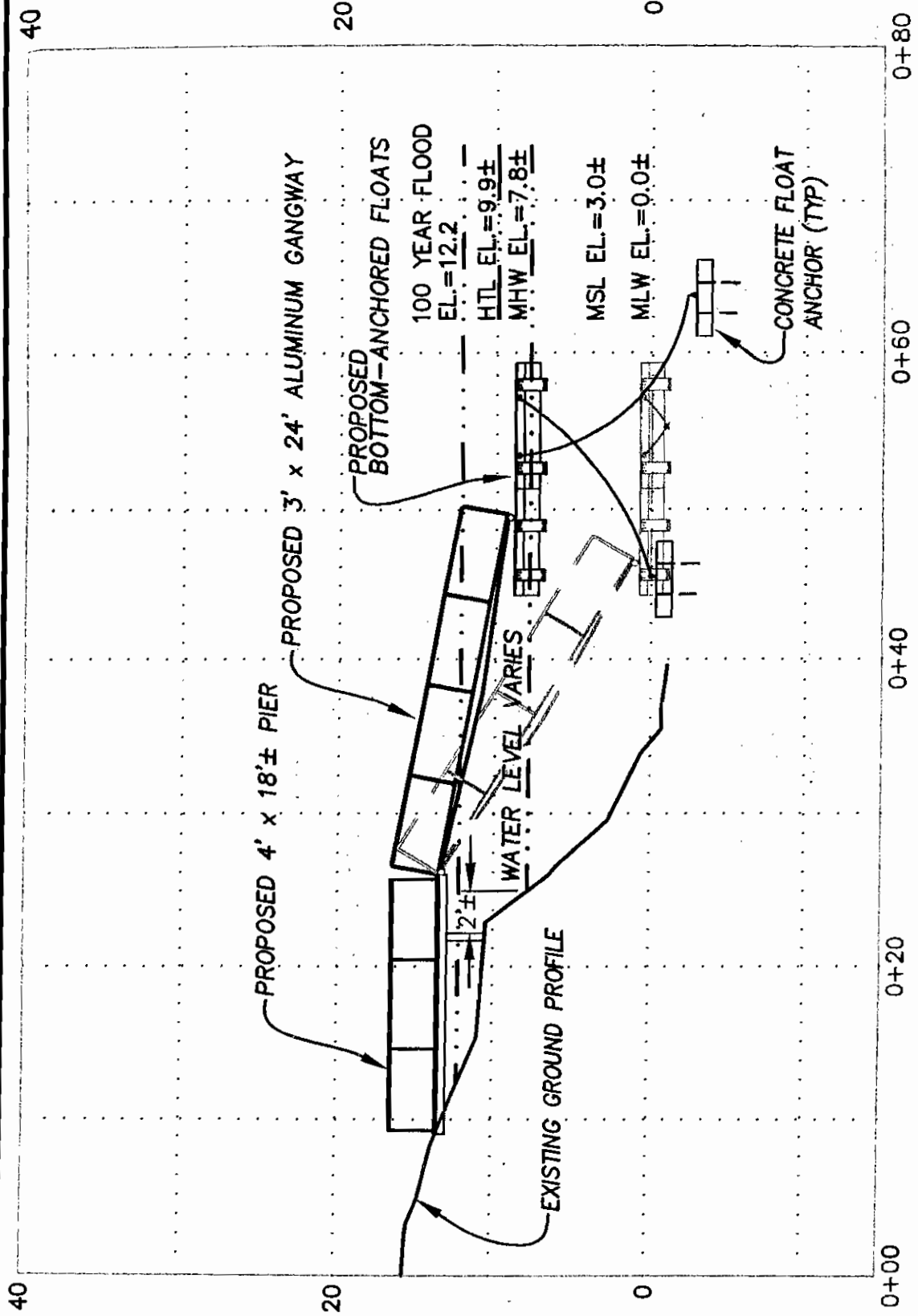

SECTION A-A
 SCALE: HOR. 1"=10'
 VERT. 1"=10'

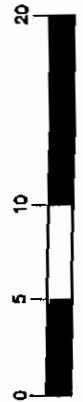

PORT ENGINEERING ASSOCIATES, INC. ONE HARRIS STREET, NEWBURYPORT, MA

PLAN ACCOMPANYING PETITION OF:
 EMMETT & CAROLYN HORGAN
 TO CONSTRUCT AN ELEVATED BOARDWALK, GANGWAY AND
 BOTTOM ANCHORED FLOATS IN THE MERRIMACK RIVER,
 NEWBURYPORT, MA, ESSEX COUNTY
 NOAA-NOS/GENED TIDAL DATUM PROJECT
 MLW=0.00, MHW=7.80±
 (CONVERSION: MSL=MLW-3.0)
 MARCH 20 2007. 054 04 47 /07

CUT-AWAY PLAN VIEW OF PIER

NOT TO SCALE

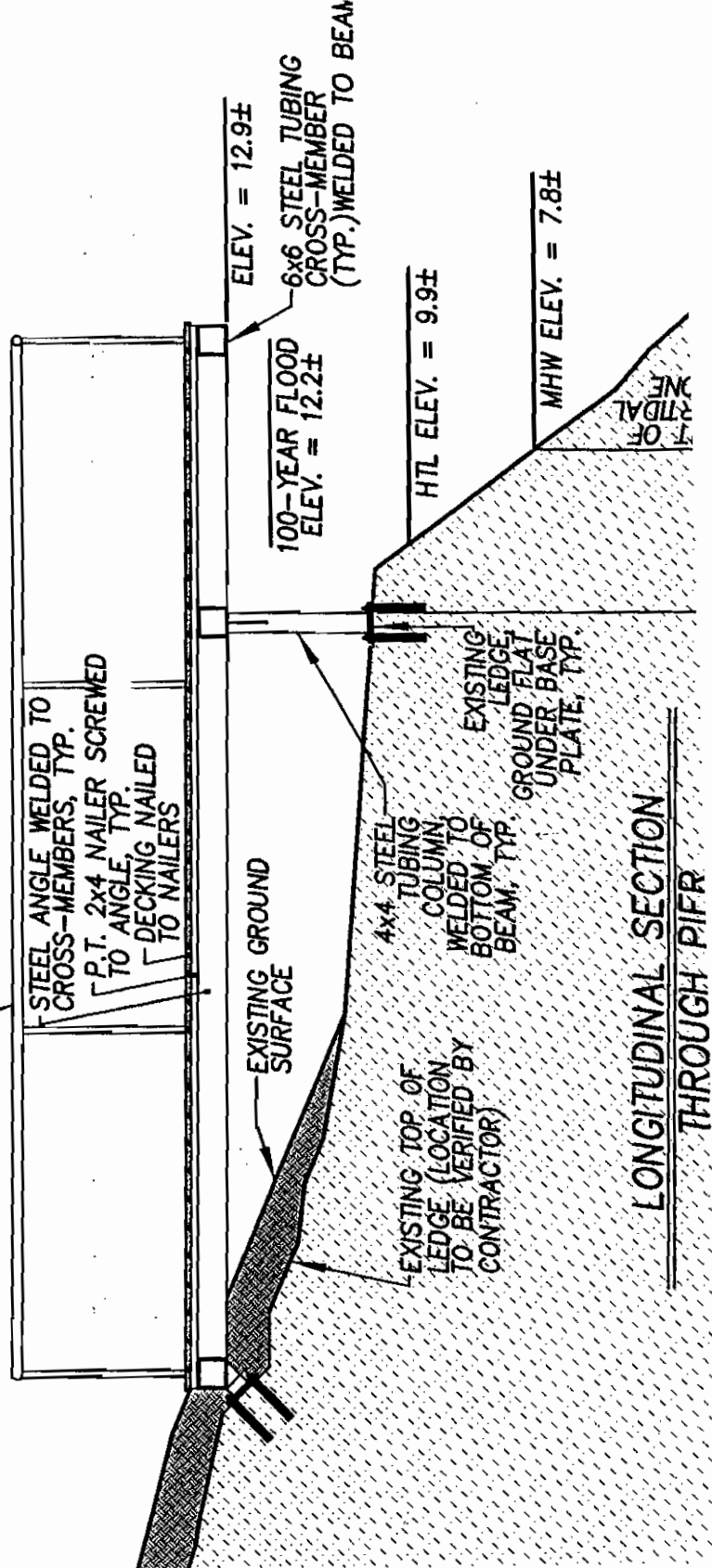
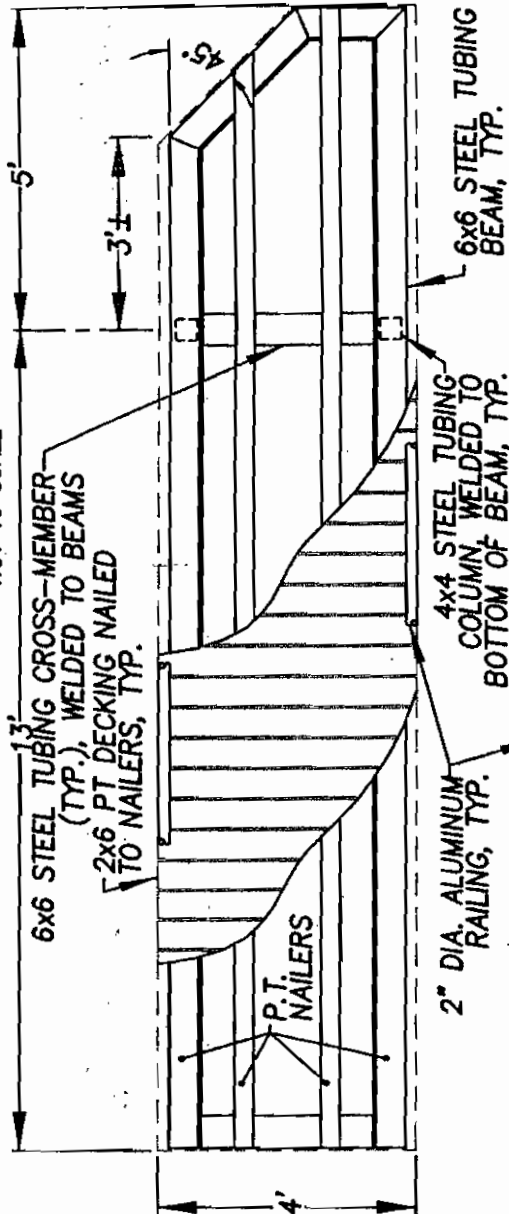

LONGITUDINAL SECTION THROUGH PIER

PORT ENGINEERING ASSOCIATES, INC. ONE HARRIS STREET, NEWBURYPORT, MA

PLAN ACCOMPANYING PETITION OF:
EMMETT & CAROLYN HORGAN
TO CONSTRUCT AN ELEVATED BOARDWALK, GANGWAY AND
BOTTOM ANCHORED FLOATS IN THE MERRIMACK RIVER,
NEWBURYPORT, MA, ESSEX COUNTY
NOAA-NOS/CENED TIDAL DATUM PROJECT
MLW=0.00, MHW=7.80±
(CONVERSION: MSL=MLW-3.0)
MARCH 29, 2007; REV: 04/17/07

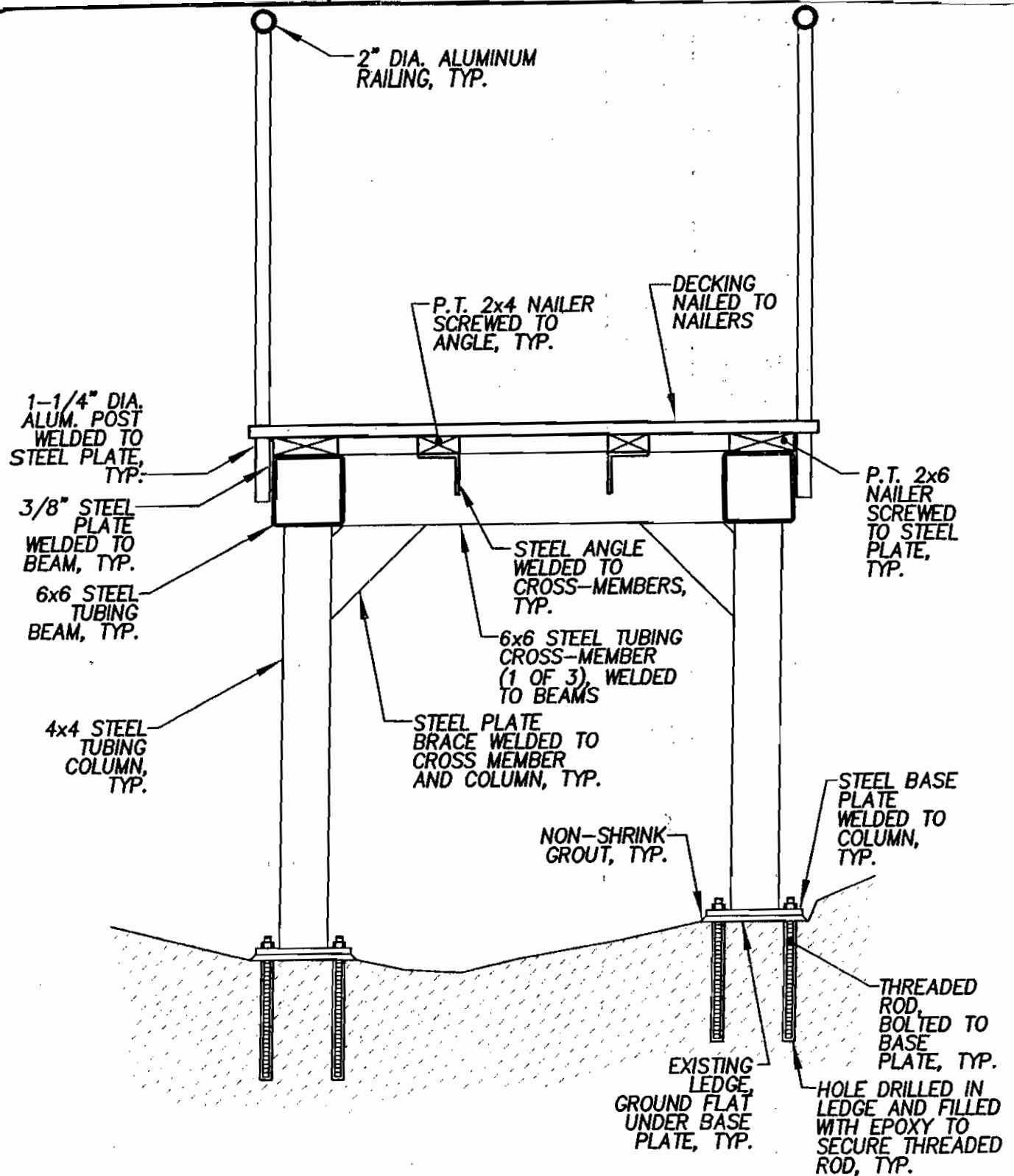

**CROSS SECTION
THROUGH PIER**
NOT TO SCALE

PORT ENGINEERING ASSOCIATES, INC. ONE HARRIS STREET, NEWBURYPORT, MA

PLAN ACCOMPANYING PETITION OF:
EMMETT & CAROLYN HORGAN
TO CONSTRUCT AN ELEVATED BOARDWALK, GANGWAY AND
BOTTOM ANCHORED FLOATS IN THE MERRIMACK RIVER,
NEWBURYPORT, MA, ESSEX COUNTY
NOAA-NOS/CENED TIDAL DATUM PROJECT
MLW=0.00, MHW=7.80±
(CONVERSION: MSL=MHW-3.0)

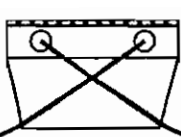

DETERMINED BY INSTALLER)
SECURED AT ANCHOR AND FLOAT

S.S. EYE BOLT SET IN
CONCRETE ANCHOR
4'X4-1/4" ROD

TYPICAL FLOAT ANCHOR DETAIL

NOT TO SCALE

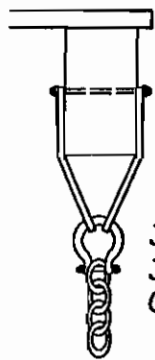

3/4" S.S. BOLT THROUGH
3/8" S.S. TANG, EACH SIDE
OF 4x8 DOCK FRAME

TYPICAL FASTENER DETAIL

NOT TO SCALE

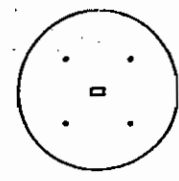

5'Ø x 12" DEPTH POURED CONCRETE
ANCHOR WITH REINFORCED 3/4"
EYELET AND 4, 4' X 1-1/4" RODS
SET INTO RIVER BED

TYPICAL CONCRETE ANCHOR DETAIL

NOT TO SCALE

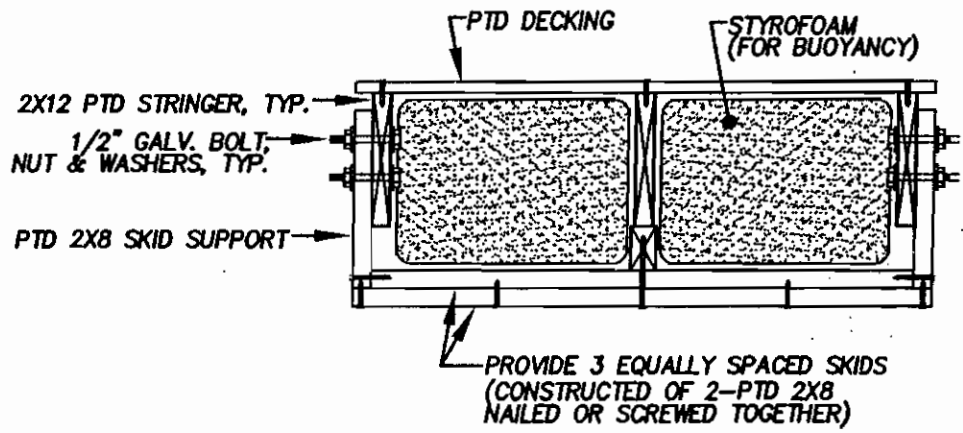

TYPICAL FLOAT CROSS SECTION

NOT TO SCALE

PORT ENGINEERING ASSOCIATES, INC. ONE HARRIS STREET, NEWBURYPORT, MA

PLAN ACCOMPANYING PETITION OF:
EMMETT & CAROLYN HORGAN
TO CONSTRUCT AN ELEVATED BOARDWALK, GANGWAY AND
BOTTOM ANCHORED FLOATS IN THE MERRIMACK RIVER,
NEWBURYPORT, MA, ESSEX COUNTY
NOAA-NOS/CENED TIDAL DATUM PROJECT
MLW=0.00, MHW=7.80±
(CONVERSION: MSL=MLW-3.0)
MARCH 29, 2007; REV: 04/17/07