

**DEPARTMENT OF ENVIRONMENTAL PROTECTION
WATERWAYS REGULATION PROGRAM**

**Notice of License Application pursuant to M. G. L. Chapter 91
Waterways License Application Number W09-2641
John Grossi**

NOTIFICATION DATE: April 10, 2009

Public notice is hereby given of the application by John Grossi to amend the existing DEP License No. 10046 by reconfiguring the dock, ramp and floats at 435 Main Street in the municipality of Amesbury in and over flowed tidelands of Merrimack River. The proposed use of the project is to provide docking and boating access to navigable waters and is a water dependent project.

The Department will consider all written comments on this Waterways application received by within 30 days subsequent to the "Notification Date". Failure of any aggrieved person or group of ten citizens or more to submit written comments to the Waterways Regulation Program by the Public Comments Deadline will result in the waiver of any right to an adjudicatory hearing in accordance with 310 CMR 9.13(4)(c).

Additional information regarding this application may be obtained by contacting the Waterways Regulation Program at (617) 292-5500. Project plans and documents for this application are on file with the Waterways Regulation Program for public viewing, by appointment only, at the address below. Written comments must be addressed to: David Slagle, MassDEP - WRP, One Winter St., 5th fl., Boston, MA 02108.

GRAPHIC SCALE

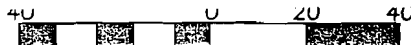

1" = 40 FT.

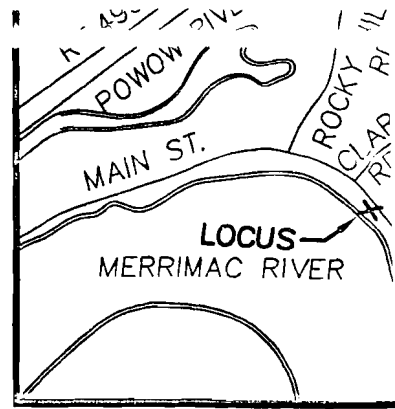

N.T.S.

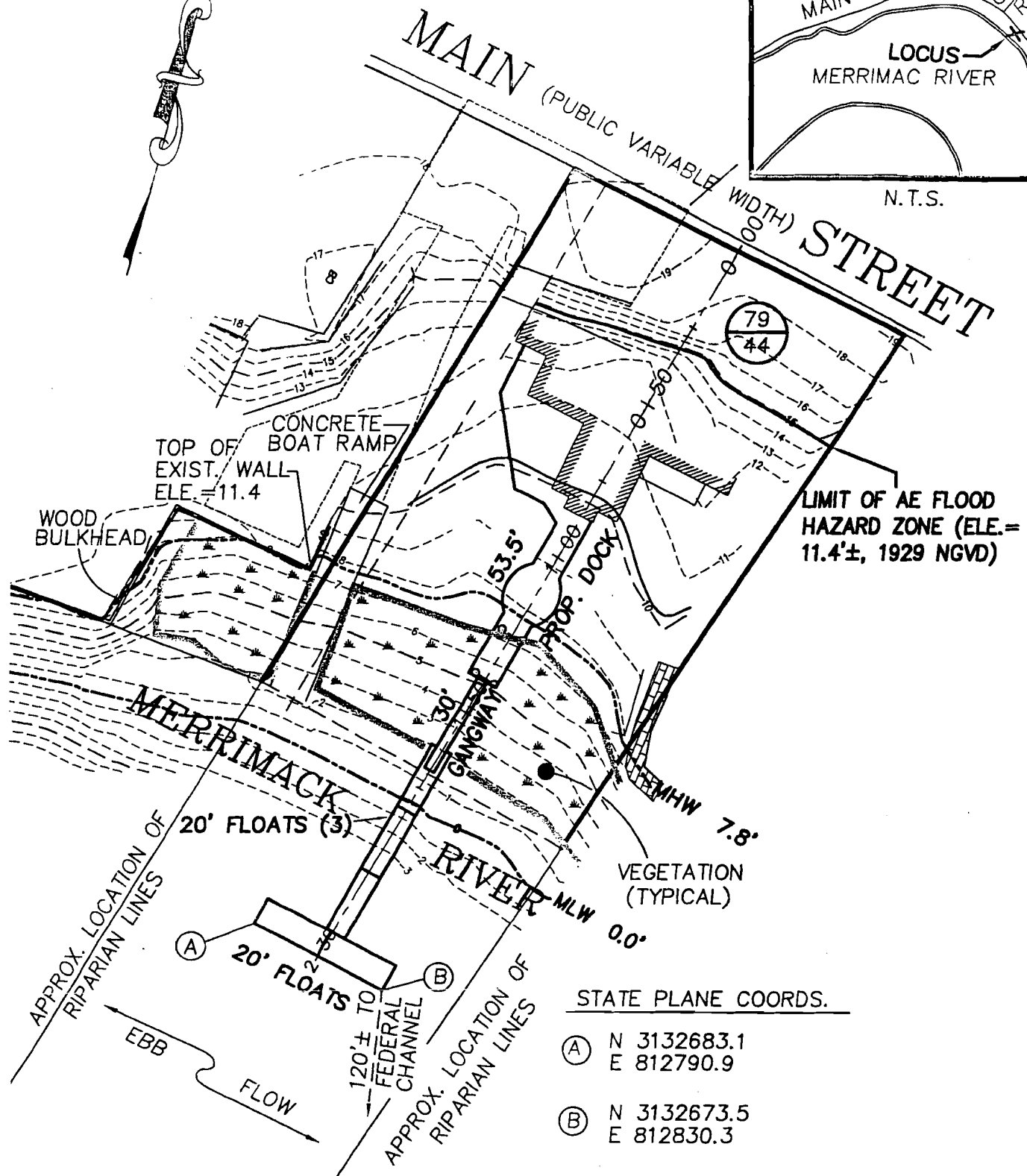

STATE PLANE COORDS.

- (A) N 3132683.1
E 812790.9
- (B) N 3132673.5
E 812830.3

PLAN TO AMEND LICENSE #10046

JOHN GROSSI
435 MAIN ST. AMESBURY, MA 01913

ASSESSOR'S MAP 79 LOT 44
MERRIMACK RIVER, NEWBURYPORT, MA

MILLENNIUM ENGINEERING, INC.
62 ELM STREET, SALISBURY, MA 01952

DATE: FEB. 18, 2009

SH. 1 OF 3

PROFILE VIEW
 PROPOSED WALKWAY,
 GANGWAY & FLOATS

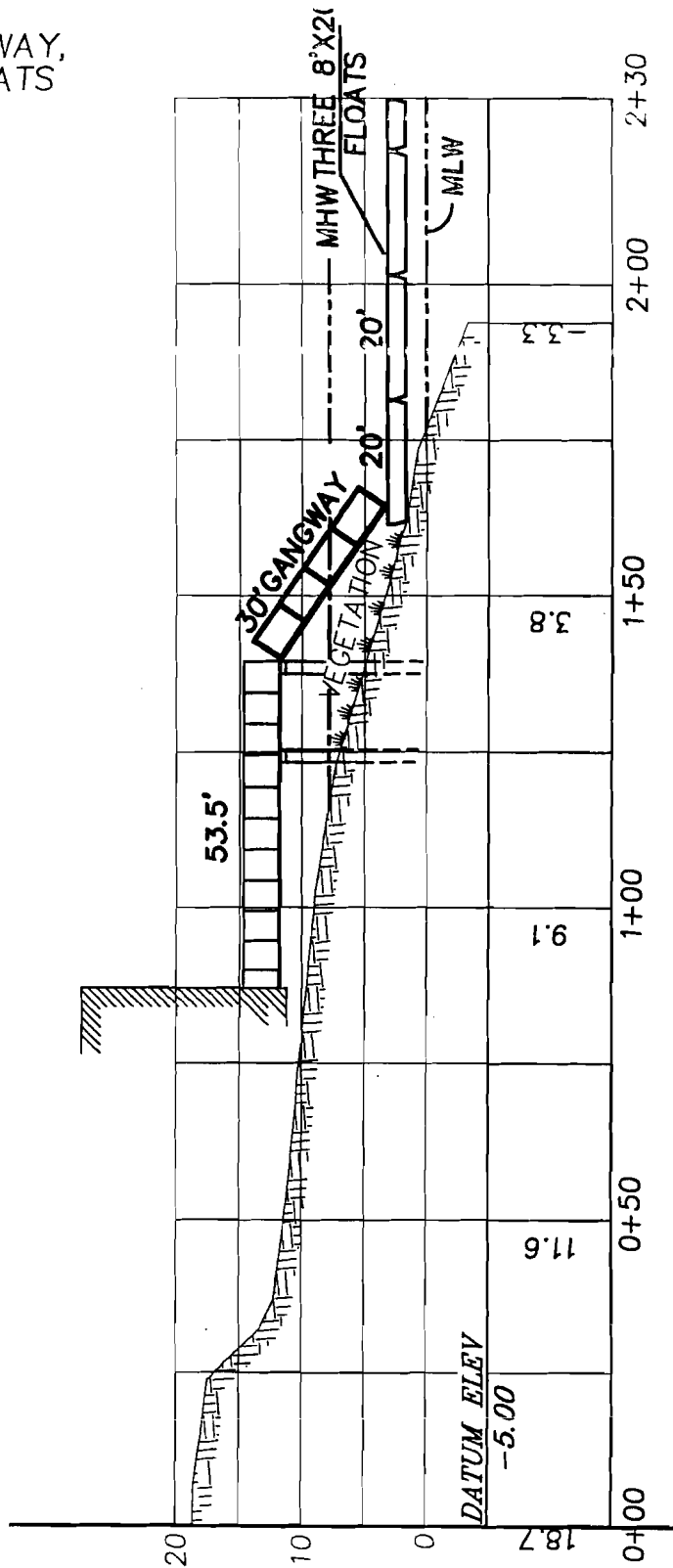

PROFILE
 SCALE HOR. 1"=30'
 VERT. 1"=15'

PLAN TO AMEND LICENSE#10046

JOHN GROSSI
 435 MAIN ST. AMESBURY, MA 01913

ASSESSOR'S MAP 79 LOT 44
 MERRIMACK RIVER, NEWBURYPORT, MA

MILLENNIUM ENGINEERING, INC.
 62 ELM STREET, SALISBURY, MA 01952

SECTION VIEWS
PROPOSED WALKWAY
AND FLOATS

NOTE: DETAILS SHOWN ARE FOR PERMITTING PURPOSES ONLY AND ARE NOT INTENDED TO BE USED FOR ACTUAL CONSTRUCTION.

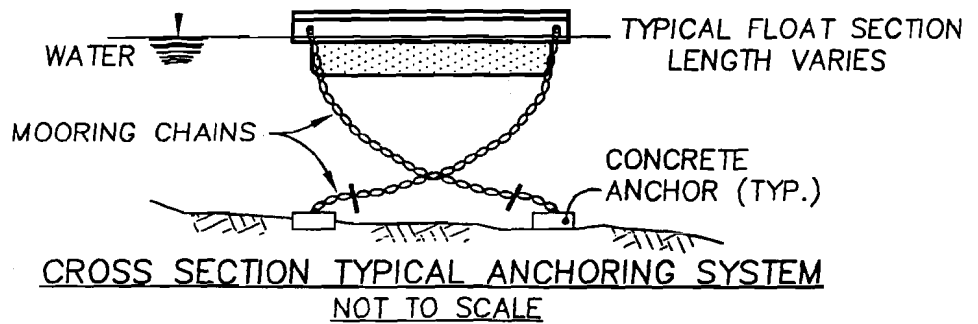
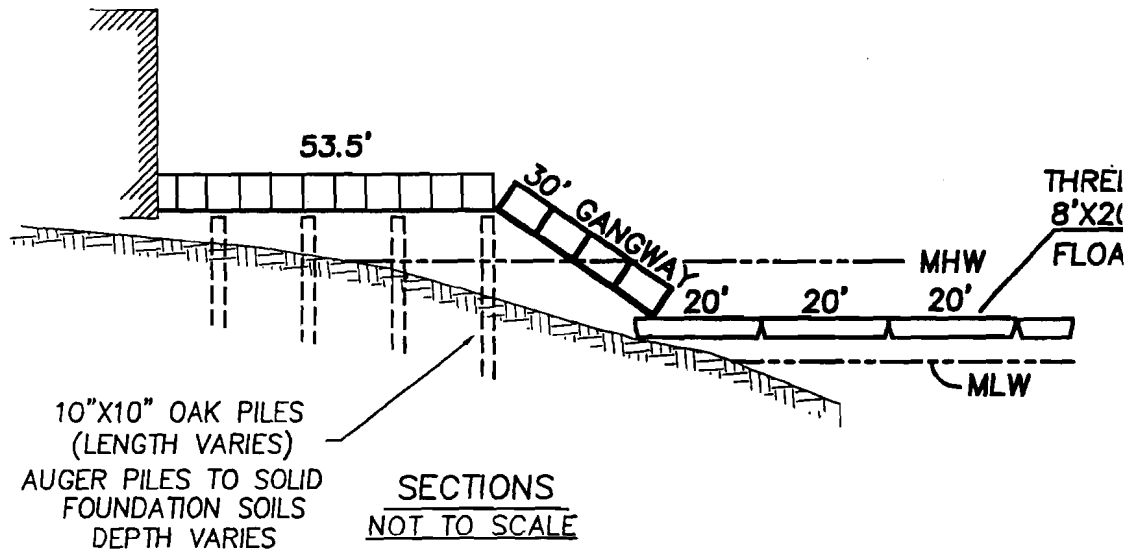
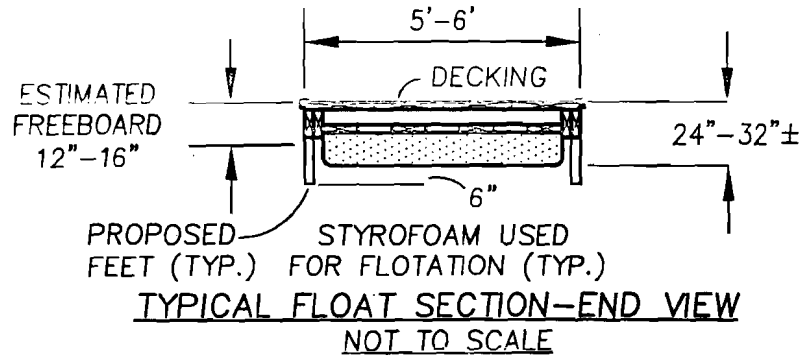

PLAN TO AMEND LICENSE #10046

JOHN GROSSI
435 MAIN ST. AMESBURY, MA 01913

ASSESSOR'S MAP 79 LOT 44
MERRIMACK RIVER, NEWBURYPORT, MA

MILLENNIUM ENGINEERING, INC.
62 ELM STREET, SALISBURY, MA 01952

DATE: FEB 18 2009

SH 3 OF 3